

# MULTIMODAL ACCESS CLOSURE EXCEPTION APPLICATION FORM AND CHECKLIST

---

Submittal Date: 2/4/25  New Submittal  Re-Submittal No: \_\_\_\_\_

Related Building Permit No: N/A

Project Name: 4701 Chalmers Drive

Street Name Location: Hildreth Drive

Between: Tara Drive And: Chalmers Drive

---

Applicant Name: Walker Building Group, LLC

Address: 2617 Locust Street Nashville, TN

Phone: 615-829-0896 Fax: \_\_\_\_\_ Contact: Chandler Capps

Email: ccapps@walkerbuildinggroup.com

---

Project Description: Replace existing CMP crossdrain with poured in place concrete box culvert

---

Start Date: 2/10/25 End Date: 4/18/25 Project Length: 67

Describe Type of Closure: Road closure from Chalmers Drive side of Hildreth Drive to Tara Drive

Only 3 driveways inside of road closure that will still have access to their driveways.

---

---

Provide Reasons why Project cannot be completed without closures and what other options were considered (attach documents as needed): The project requires the install of an 18' wide box culvert underneath Hildreth Drive that has to be poured in place. As well as well as a section of sanitary sewer pipe replacement and new xypex sewer manhole.

---

---

---

## PROJECT INFORMATION CHECKLIST:

Included Not Applicable

- |                                     |                                     |  |
|-------------------------------------|-------------------------------------|--|
| <input checked="" type="checkbox"/> | <input type="checkbox"/>            | Project Vicinity Map with Project Area shown, street names, property information, existing pavement and striping, gutter and building locations, north arrow, and scale. |
| <input checked="" type="checkbox"/> | <input type="checkbox"/>            | Planned work hours included.   |
| <input checked="" type="checkbox"/> | <input type="checkbox"/>            | Exact location and dimensions of the construction work zone shown.   |
| <input type="checkbox"/>            | <input checked="" type="checkbox"/> | If multiple phases are necessary, include perimeter impact of each phase, phase number, anticipated work hours and phase duration.                                       |
| <input checked="" type="checkbox"/> | <input type="checkbox"/>            | Details on construction activity and equipment being used as part of construction included for each phase.   |
| <input type="checkbox"/>            | <input checked="" type="checkbox"/> | Specify if any on-street parking, and/or metered parking, is to be restricted and if bus zone will need to be relocated.   |
| <input checked="" type="checkbox"/> | <input type="checkbox"/>            | Specify if trash pickup will be impacted.  |
| <input type="checkbox"/>            | <input checked="" type="checkbox"/> | Provide information on all utility work and utility connections.   |
| <input checked="" type="checkbox"/> | <input type="checkbox"/>            | List all affected residents, businesses, agencies, and schools and any conversations/agreements taken place.   |
| <input type="checkbox"/>            | <input checked="" type="checkbox"/> | Show ongoing construction projects within vicinity of proposed project impact.   |
| <input type="checkbox"/>            | <input checked="" type="checkbox"/> | Provide plan to address conflicts with other nearby projects.  |
| <input checked="" type="checkbox"/> | <input type="checkbox"/>            | Provide traffic control plan for each phase of construction (see traffic control checklist for more information).  |
| <input checked="" type="checkbox"/> | <input type="checkbox"/>            | Provide information on work vehicle parking locations.   |
| <input checked="" type="checkbox"/> | <input type="checkbox"/>            | Show construction trucks ingress/egress to project location.   |
| <input type="checkbox"/>            | <input checked="" type="checkbox"/> | Provide information on any traffic signals, traffic signal loops, and traffic signal cabinets in close proximity to project.   |

## TRAFFIC CONTROL PLAN CHECKLIST:

Included Not Applicable

- All temporary traffic control plans shall be designed in accordance with the most recent ADA regulations and requirements of the Manual of Uniform Traffic Control Devices.
- Clearly show the locations of all existing signs (including speed limit) as well as the proposed signs for each construction phase.
- Show the location of all existing pedestrian paths and pedestrian detour route of each stage of construction.
- Show dimensions of travel lane width, shoulder width, sidewalk of each phase, and overall roadway width along the length of affected area.
- Show all existing striping and markings to remain, to be removed, and all proposed striping and markings for each construction stage.
- Provide detour plan clearly showing detour route for any roadway or pedestrian/bike path closures.
- Specify placement of all temporary traffic control devices.
- Specify spacing of all temporary traffic control devices.
- Show all existing traffic signals and streetlights in the work zone location.
- Lighting provided for all pedestrian detour routes.
- Provide minimum eleven (11) foot travel lanes at all times.
- Show size, height, and location of all channelizing devices, warning lights, flag trees, barriers, etc.
- Label all taper lengths and widths.
- Provide locations of police officers for each phase as needed.
- Temporary Traffic Control Plan has been stamped and signed by a TN licensed Civil Engineer.

# Map

Work Hours - 7 am to 5 pm

Dump Truck, 308 excavator and loader being used

Traffic Officer at each end for the first 2 weeks of closure

# Legend

 4701 Chalmers Dr



Road Closed

Box Culvert Install

Road Closed

Truck ingress and egress

4701 Chalmers Dr



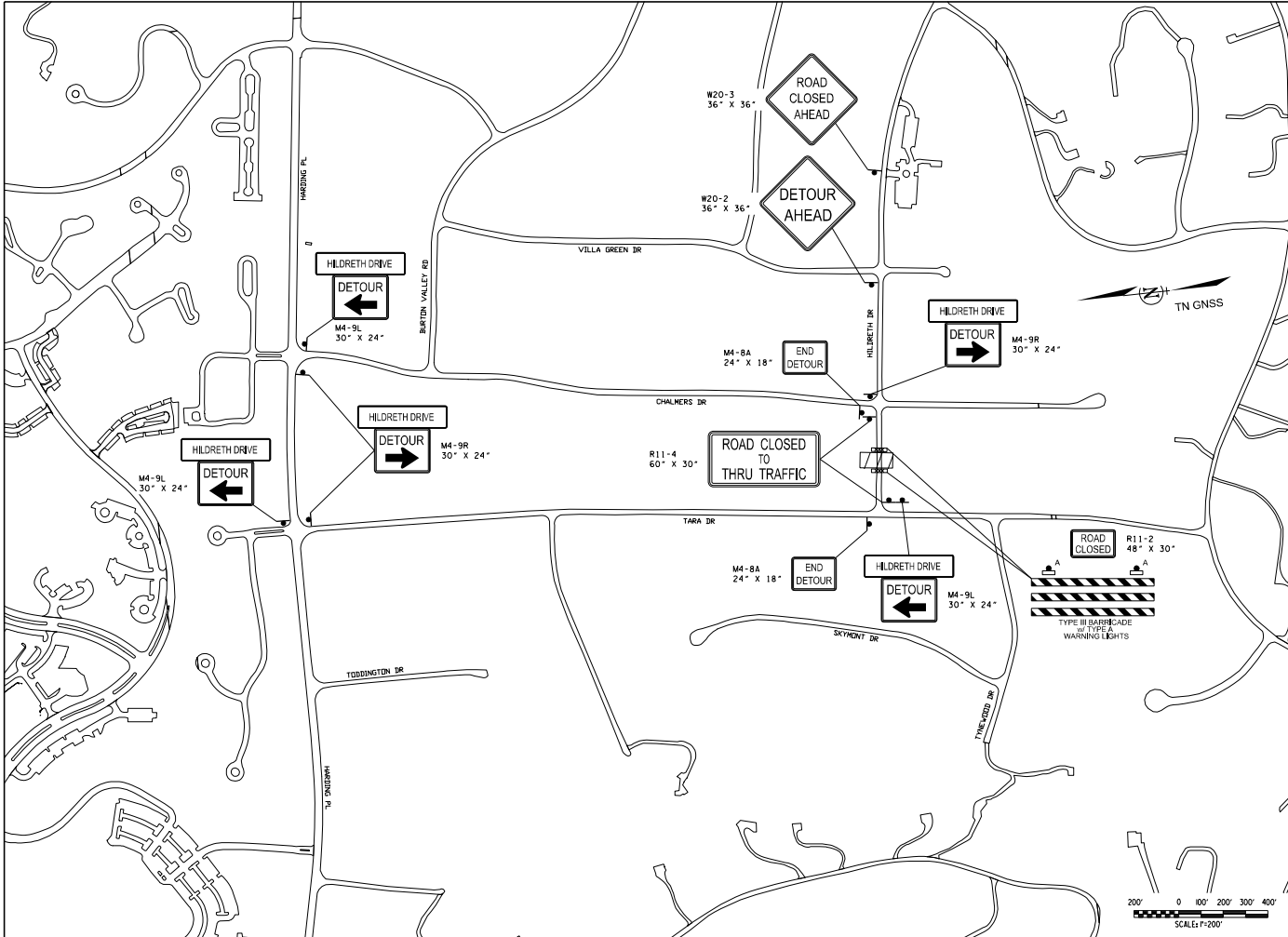

FILE NO.	CHALMERS DRIVE
DATE:	01-10-2024
DESIGNED BY:	ADS
DRAWN BY:	ADS
CHECKED BY:	DWG
REVISION BLOCK	
DATE:	
DATE:	
DATE:	

CONSOR ENGINEERS, LLC  
 101 WESTPARK DRIVE, SUITE 300  
 BRENTWOOD, TN 37027  
 (615) 452-2000

SEALED BY



METROPOLITAN GOVERNMENT  
 OF WASHINGTON COUNTY, TENNESSEE  
 METROPOLITAN ENGINEER  
 STORMWATER DESIGN

CHALMERS DRIVE  
 STORMWATER  
 IMPROVEMENTS

TRAFFIC CONTROL PLAN

SCALE: 1" = 200'  
 SHEET 06 OF 09