

# MULTIMODAL ACCESS CLOSURE EXCEPTION APPLICATION FORM AND CHECKLIST

---

Submittal Date: February 6, 2025  New Submittal  Re-Submittal No: \_\_\_\_\_

Related Building Permit No: \_\_\_\_\_

Project Name: Walt Grace Vintage

Street Name Location: 701 Ewing Avenue

Between: Ewing Avenue and Middleton St And: alleyways

---

Applicant Name: Clear Blue Construction

Address: 601 Woodland Street, Nashville, TN 37206

Phone: (470) 597-4872 Fax: \_\_\_\_\_ Contact: Will Hyché

Email: will.hyché@theclearbluecompany.com

---

Project Description: Redevelopment of 701 Ewing Street

---

Start Date: March 1, 2025 End Date: October 1, 2025 Project Length: 7 months

Describe Type of Closure: Full closure of alley #141 between Middleton Street and Alley #140,

Full closure of sidewalks on block at 701 Ewing Avenue (Ewing Avenue and Middleton Street)

---

---

**Provide Reasons why Project cannot be completed without closures and what other options were considered (attach documents as needed):** \_\_\_\_\_

This project is a full redevelopment of 701 Ewing Ave and includes reconstruction of  
the sidewalks within the block. During construction, access will be restricted for safety  
of the public.

---

---

## PROJECT INFORMATION CHECKLIST:

Included Not Applicable

- |                                     |                                     |  |
|-------------------------------------|-------------------------------------|--|
| <input checked="" type="checkbox"/> | <input type="checkbox"/>            | Project Vicinity Map with Project Area shown, street names, property information, existing pavement and striping, gutter and building locations, north arrow, and scale. |
| <input checked="" type="checkbox"/> | <input type="checkbox"/>            | Planned work hours included.   |
| <input checked="" type="checkbox"/> | <input type="checkbox"/>            | Exact location and dimensions of the construction work zone shown.   |
| <input type="checkbox"/>            | <input checked="" type="checkbox"/> | If multiple phases are necessary, include perimeter impact of each phase, phase number, anticipated work hours and phase duration.                                       |
| <input type="checkbox"/>            | <input checked="" type="checkbox"/> | Details on construction activity and equipment being used as part of construction included for each phase.   |
| <input type="checkbox"/>            | <input checked="" type="checkbox"/> | Specify if any on-street parking, and/or metered parking, is to be restricted and if bus zone will need to be relocated.   |
| <input type="checkbox"/>            | <input checked="" type="checkbox"/> | Specify if trash pickup will be impacted.  |
| <input type="checkbox"/>            | <input checked="" type="checkbox"/> | Provide information on all utility work and utility connections.   |
| <input type="checkbox"/>            | <input checked="" type="checkbox"/> | List all affected residents, businesses, agencies, and schools and any conversations/agreements taken place.   |
| <input type="checkbox"/>            | <input checked="" type="checkbox"/> | Show ongoing construction projects within vicinity of proposed project impact.   |
| <input type="checkbox"/>            | <input checked="" type="checkbox"/> | Provide plan to address conflicts with other nearby projects.  |
| <input checked="" type="checkbox"/> | <input type="checkbox"/>            | Provide traffic control plan for each phase of construction (see traffic control checklist for more information).  |
| <input checked="" type="checkbox"/> | <input type="checkbox"/>            | Provide information on work vehicle parking locations.   |
| <input checked="" type="checkbox"/> | <input type="checkbox"/>            | Show construction trucks ingress/egress to project location.   |
| <input type="checkbox"/>            | <input checked="" type="checkbox"/> | Provide information on any traffic signals, traffic signal loops, and traffic signal cabinets in close proximity to project.   |

## TRAFFIC CONTROL PLAN CHECKLIST:

Included Not Applicable

- All temporary traffic control plans shall be designed in accordance with the most recent ADA regulations and requirements of the Manual of Uniform Traffic Control Devices.
- Clearly show the locations of all existing signs (including speed limit) as well as the proposed signs for each construction phase.
- Show the location of all existing pedestrian paths and pedestrian detour route of each stage of construction.
- Show dimensions of travel lane width, shoulder width, sidewalk of each phase, and overall roadway width along the length of affected area.
- Show all existing striping and markings to remain, to be removed, and all proposed striping and markings for each construction stage.
- Provide detour plan clearly showing detour route for any roadway or pedestrian/bike path closures.
- Specify placement of all temporary traffic control devices.
- Specify spacing of all temporary traffic control devices.
- Show all existing traffic signals and streetlights in the work zone location.
- Lighting provided for all pedestrian detour routes.
- Provide minimum eleven (11) foot travel lanes at all times.
- Show size, height, and location of all channelizing devices, warning lights, flag trees, barriers, etc.
- Label all taper lengths and widths.
- Provide locations of police officers for each phase as needed.
- Temporary Traffic Control Plan has been stamped and signed by a TN licensed Civil Engineer.

# PERMIT APPLICATION

NASHVILLE DEPARTMENT of TRANSPORTATION  
& MULTIMODAL INFRASTRUCTURE

720 South Fifth Street

Nashville, TN 37206

Phone #: 862-8782 [PWpermits@Nashville.gov](mailto:PWpermits@Nashville.gov)

Mark Which Type Permit Applying For:

- |   |   |
|---|---|
| <input type="checkbox"/> LANE CLOSURE/RIGHT-OF-WAY PERMIT   | <input type="checkbox"/> TRAILER/DUMPSTER/STORAGE UNIT PERMIT |
| <input checked="" type="checkbox"/> STREET CLOSURE PERMIT   | <input type="checkbox"/> NEW DRIVEWAY PERMIT                  |
| <input checked="" type="checkbox"/> SIDEWALK CLOSURE PERMIT | <input type="checkbox"/> PARKING/LOADING ZONE PERMIT          |

Will this permit request cause the continuous closure of a sidewalk, bike path, or street for 7 days or more?

Yes  No

Today's Date February 6, 2024

Company Name: Clear Blue Construction

Company Address: 601 Woodland Street, Nashville, TN 37206

Contact Name: Will Hyche or Hunter Kennedy After Hours/Emergency Phone #: (470) 597-4872 OR 205-602-4572

Phone #: (470) 597-4872 Fax #: ( )

Email Address: will.hyche@theclearbluecompany.com

Street Location: 701 Ewing Avenue (at Middleton Street)

Sidewalk Location: Full closure of the sidewalk between alleyway and Ewing Avenue. Closure of alley west of Ewing between Middleton Street and Alleway to south of Middleton Street, temporary pedestrian walkway along Ewing Avenue

From Intersection: N/A To Intersection: N/A

Work being performed: Walt Grace Vintage development

**\*\*You must also include a description of work narrative including project vicinity map, the exact location and dimensions of the construction work zone, and a description of the phases of work to be performed when submitting this application.**

Number of Days Needed: 213 Start Date: March 1, 2025

Proposed daily work schedule of activities (preferred work hours): 6am - 8pm

Work Weekends:  Yes  No

Requested By: Will Hyche Will Hyche  
Signature Print Name

**\*\*Note: By signing you agree that you have read and understood the attached Chapter 13.20.020 notice attached.**

Office Use Only:

Received By: \_\_\_\_\_

Payment Type: \_\_\_\_\_

Permit Number: \_\_\_\_\_

Permit Fee: \_\_\_\_\_



METROPOLITAN GOVERNMENT OF NASHVILLE AND DAVIDSON COUNTY

JOHN COOPER  
MAYOR

NASHVILLE DEPARTMENT OF TRANSPORTATION  
AND MULTIMODAL INFRASTRUCTURE

### **Chapter 13.20.020 Excavations and Obstruction Permissions and Notice Required**

According to the referenced Code on Excavations and Obstructions in Metro Right of Way: “no excavation may be undertaken in any street, road, alley or right of way or of any utility or temporary construction easement of the Metropolitan Government or other government entity by any department of the metropolitan government or any other entity unless notice as required herein has been given”.

**All contractors performing excavations in Metro right of way are required to provide 1 to 2 weeks of advance notice to the homeowners, residents, and businesses along the streets where the work is being performed.** Your company must provide some form of documentation or proof that you have given adequate advance notice of your project. *Failure to do so could result in a triple fee fine to your permit.*

Attached is an example of what the door hangers or mailers should look like.

Please contact [PWPermits@Nashville.gov](mailto:PWPermits@Nashville.gov) or 615-862-8782 if you have any questions.

**NDOT**

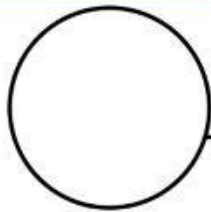

**Mayor  
John Cooper**

*NASHVILLE DEPARTMENT OF TRANSPORTATION  
& MULTIMODAL INFRASTRUCTURE*

Please be informed that a project for Utility Work will begin in approximately 1-2 weeks depending on weather conditions.

FOR ADDITIONAL INFORMATION CONTACT

Contractor \_\_\_\_\_

Contact Person \_\_\_\_\_

Phone # \_\_\_\_\_

Type of Work \_\_\_\_\_

**NDOT** (Formerly Public Works)

Phone #  
615-862-8782

We appreciate your cooperation.

 To Request this information in an alternate format or ADA accommodations, please contact

Rick Kirkpatrick  
615-862-8750

**PROJECT NOTIFICATION**

**NDOT**

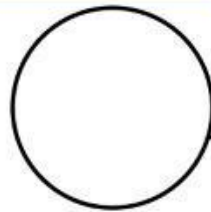

**Mayor  
John Cooper**

*NASHVILLE DEPARTMENT OF TRANSPORTATION  
& MULTIMODAL INFRASTRUCTURE*

Please be informed that a project for Utility Work will begin in approximately 1-2 weeks depending on weather conditions.

FOR ADDITIONAL INFORMATION CONTACT

Contractor \_\_\_\_\_

Contact Person \_\_\_\_\_

Phone # \_\_\_\_\_

Type of Work \_\_\_\_\_

**NDOT** (Formerly Public Works)

Phone #  
615-862-8782

We appreciate your cooperation.

 To Request this information in an alternate format or ADA accommodations, please contact

Rick Kirkpatrick  
615-862-8750

**PROJECT NOTIFICATION**

**Nashville Department of Transportation**

**Change from Lane Closure to Street Closure Policy**

Change from Lane Closure to Street Closure after Permit is Issued:

A Street Closure Application and Traffic Plan from a Licensed Traffic Engineer must be submitted for approval to the NDOT Permit Office to change the Permit issued for a Lane Closure to a Street Closure. All requests are assessed based on the scope of work, time required, and impacts to pedestrian and vehicular traffic. Street Closure request is reviewed and restrictions such as work times and need for Safety Officers/Traffic Management are based on the location, knowledge of traffic flows, existing permits already issued, and impacts to the public.

If a Street Closure is requested by the contractor for a permit with an existing Lane Closure, a meeting will be scheduled by the inspector with the contractor and the Permit Administrator to review the conditions and requirements. At that time if there is a need to adjust the Lane Closure parameters the inspector directs the contractor to request the change via e-mail to the Permit Office. The inspector will notify the Permit Office via email of their agreement with the request. If there is a need for a Street Closure, the contractor shall submit a traffic plan from a licensed Traffic Engineer that includes a detour plan with Safety Officers, traffic control and notification of the Street Closure to all Metro entities such as OEM, MNPS, MNPd, NFD, and WeGo prior to the Street Closure. When the Street Closure Application and the Traffic Plan for the Street Closure is approved by the Permit Administrator, the original Lane Closure Permit will be revised to a Street Closure Permit and reissued. The contractor closes the road, and the inspector confirms that the plan is being followed and is working safely.

Intermittent Traffic Control (ITC) measures, in which a street is temporarily closed for a very short period (less than thirty minutes) must be documented on a Lane Closure Permit. The contractor should request this during their initial application. If during the initial site visit with the assigned inspector, if the need for ITC is identified but not clearly indicated on the permit, the contractor will need to request this addition via e-mail to the Permit Office. The inspector will notify the Permit Office via email of their agreement to add the ITC. If during the project, the need for ITC measures is identified, the contractor should notify the assigned inspector to discuss.

Change from Lane Closure to Street Closure after Permit is Issued due to Safety Conditions:

Changing a Lane Closure to a Street Closure requires following specific protocols. At any time during work if conditions at the site deteriorate such that there is an immediate traffic safety issue, the road should be immediately closed, and the contractor immediately contact the area inspector and the Permit Office. The area inspector will visit the site immediately to assess the situation associated with a potential Street Closure.

Based upon the revised approved Traffic Plan, it will be determined if variable message boards or other elements of a traffic control plan are required.

# Nashville Department of Transportation

## Change from Lane to Street Closure Procedures

1. Contractor emails Permit Office to request a change from Lane Closure to a Street closure.  
Contractor submits a Traffic Plan from a Licensed Engineer and explains in detail why the change is needed.
2. Office staff receives the email from Contractor requesting a Street Closure and will send to Permit Administrator and NDOT Traffic Engineer for approval.
3. NDOT Permit Office and Traffic Engineer require a minimum of 5 days to review and approve the Traffic Plan for the Street Closure.
4. If the Street Closure is approved by Permit Administrator and Traffic Engineer, area inspector and Permit Office will receive a copy of approved traffic plans and approved Street Closure Permit.
5. The area inspector will contact contractor with approval and conditions of the permit. Inspector will also inform the contractor that it is their responsibility to contact and update the permit with the permit office.
6. Per emailed request to the permit office, referencing Lane closure permit #, the permit office can process a new Street Closure permit at no charge and showing it was paid for on a previous Lane Closure permit.
7. Prior to construction, contractor shall meet with area inspector on site to verify traffic control measures are in place. Inspector will document approval.

# WALT GRACE TRAFFIC CONTROL PLANS

FILE NO.	00041533_001
DATE:	09/17/2024
DESIGNED BY:	TJB
DRAWN BY:	JMG
CHECKED BY:	JAM
REVISION BLOCK	
DATE:	

PROJECT LOCATION

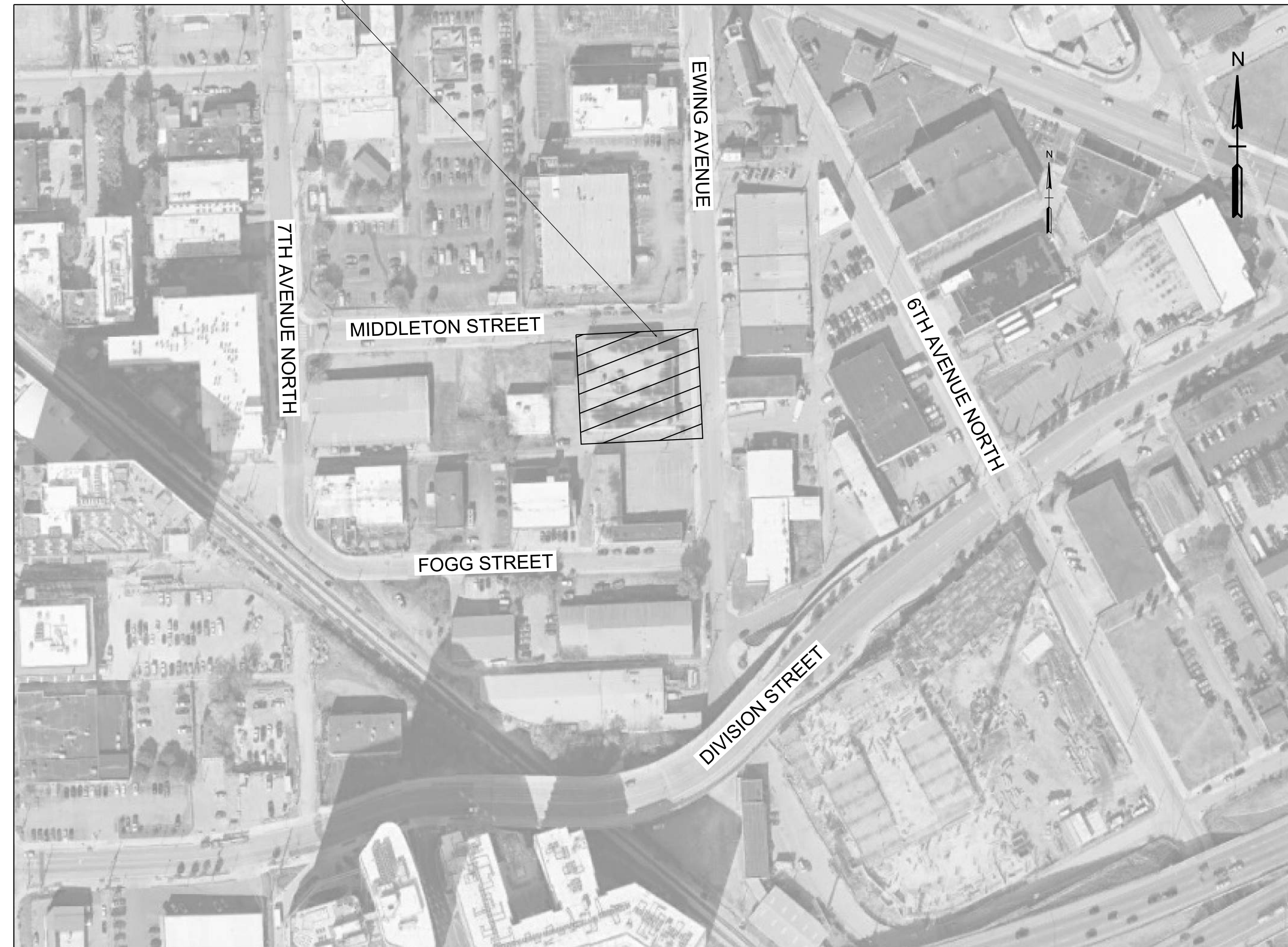

INDEX OF SHEETS	NUMBER
SHEET TITLE	
TITLE SHEET	1
PHASE 1 LAYOUT	2
GENERAL NOTES AND TYPICAL SECTIONS	3

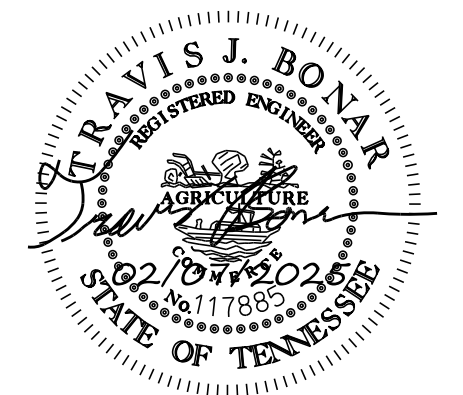

COVER SHEET

WALT  
GRACE  
TTC

TITLE SHEET

SCALE: N.T.S.

SHEET 1

SPECIAL NOTES

THIS PROJECT TO BE CONSTRUCTED UNDER THE STANDARD SPECIFICATIONS OF THE TENNESSEE DEPARTMENT OF TRANSPORTATION DATED JANUARY 1, 2021 AND ADDITIONAL SPECIFICATIONS AND SPECIAL PROVISIONS CONTAINED IN THE PLANS AND IN THE PROPOSAL CONTRACT.

DESIGNED BY: TRAVIS BONAR, P.E.  
 DESIGNER: TRAVIS BONAR, P.E.  
 P.E. NO. 117885  
 CHECKED BY JEFFREY A. MESSENGER, P.E.

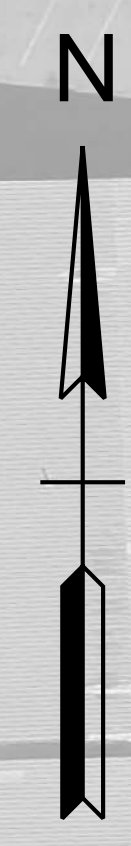
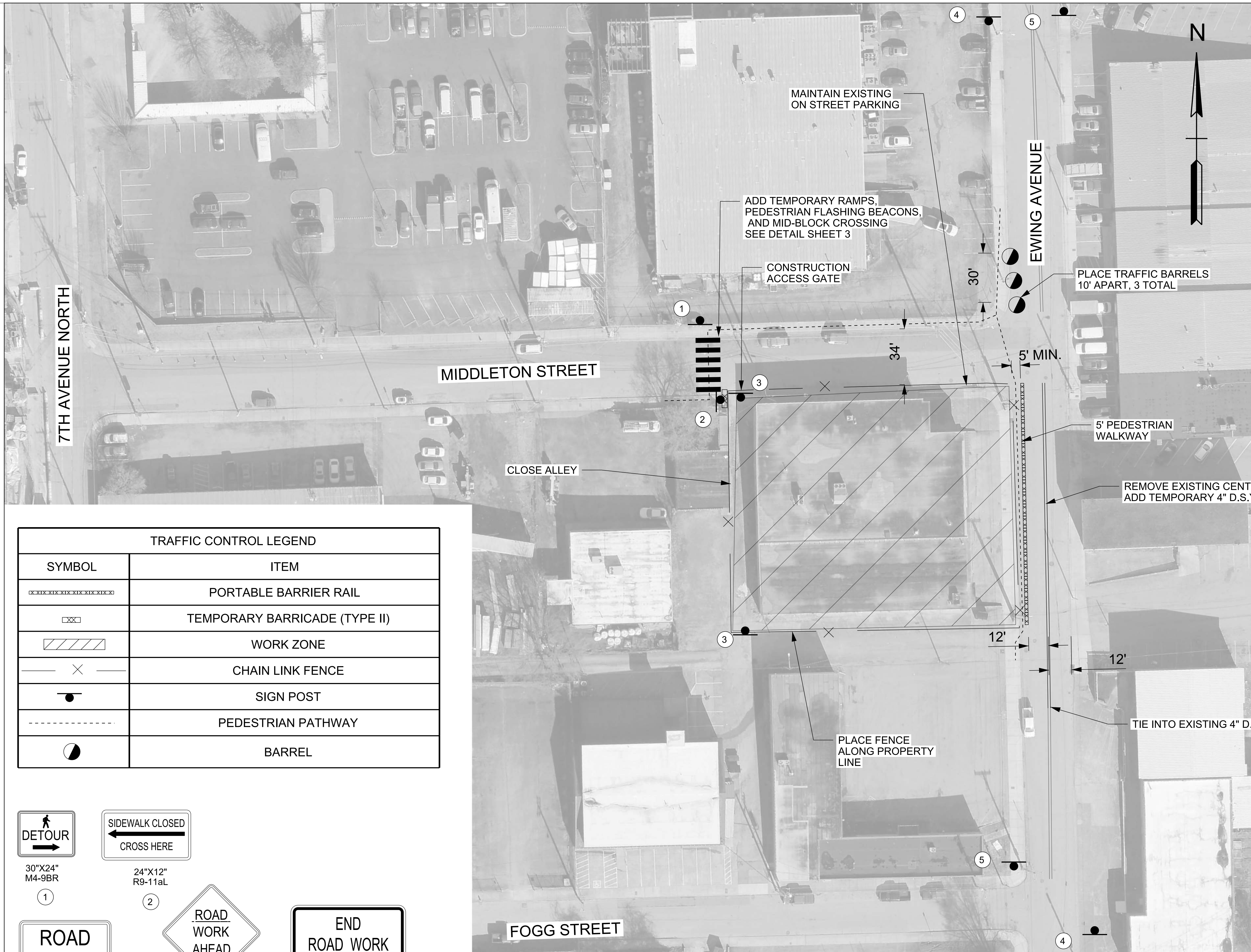

FILE NO.	00041533_001
DATE:	09/17/2024
DESIGNED BY:	TJB
DRAWN BY:	JMG
CHECKED BY:	JAM
REVISION BLOCK	
DATE:	

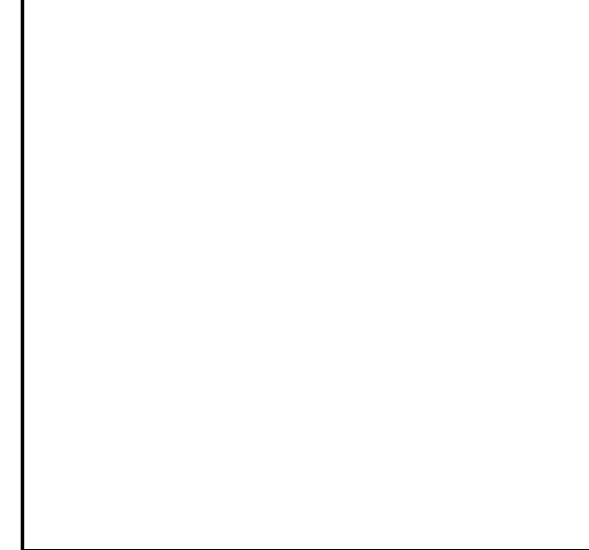

**KCI**  
TECHNOLOGIES

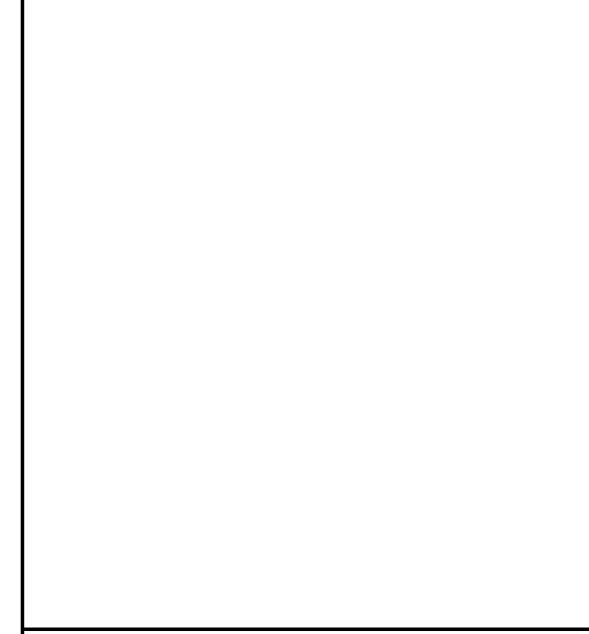

PHASE 1  
LAYOUT

WALT  
GRACE  
TTC

TCP LAYOUT

1"=30'

SHEET 2

TRAFFIC CONTROL LEGEND	
SYMBOL	ITEM
XXXXXXXXXXXXXXXX	PORTABLE BARRIER RAIL
XXXX	TEMPORARY BARRICADE (TYPE II)
////	WORK ZONE
— X —	CHAIN LINK FENCE
●	SIGN POST
----	PEDESTRIAN PATHWAY
●	BARREL

30"X24"  
M4-9BR  
①

24"X12"  
R9-11aL  
②

48"X30"  
R11-2  
③

36"X36"  
W20-1  
④

36"X18"  
G20-2  
⑤

## TRAFFIC CONTROL NOTES

### GENERAL

1. NOTHING IN THE GENERAL NOTES OR SPECIAL PROVISIONS SHALL RELIEVE THE CONTRACTOR FROM HIS RESPONSIBILITIES TOWARD THE SAFETY AND CONVENIENCE OF THE GENERAL PUBLIC AND THE RESIDENTS ALONG THE PROPOSED CONSTRUCTION AREA.
2. ALL CONSTRUCTION, EQUIPMENT, AND INSTALLATION PROCEDURES SHALL COMPLY WITH THE TENNESSEE DEPARTMENT OF TRANSPORTATION (TDOT) STANDARD SPECIFICATIONS FOR ROAD AND BRIDGE CONSTRUCTION, (AS AMENDED) AND WITH THE CURRENT STANDARDS AND SPECIFICATIONS OF METRO PUBLIC WORKS. PAVEMENT MARKING REMOVAL AND TRAFFIC CONTROL SHALL COMPLY WITH SECTION 712-TEMPORARY TRAFFIC CONTROL.

### TEMPORARY TRAFFIC CONTROL

3. ADVANCED WARNING SIGNS SHALL NOT BE DISPLAYED MORE THAN FORTY-EIGHT (48) HOURS BEFORE PHYSICAL CONSTRUCTION BEGINS. SIGNS MAY BE ERECTED UP TO ONE WEEK BEFORE NEEDED, IF THE SIGN FACE IS FULLY COVERED.
4. IF THE CONTRACTOR MOVES OFF THE PROJECT, HE SHALL COVER OR REMOVE ALL UNNEEDED SIGNS AS DIRECTED BY THE ENGINEER. COSTS OF REMOVAL, COVERING, AND REINSTALLING SIGNS SHALL NOT BE MEASURED AND PAID FOR SEPARATELY, BUT ALL COST SHALL BE INCLUDED IN THE ORIGINAL UNIT PRICE BID FOR ITEM NO 712-06, SIGNS (CONSTRUCTION) PER SQUARE FOOT.
5. A LONG TERM BUT SPORADIC USE WARNING SIGN, SUCH AS A FLAGGER SIGN, MAY REMAIN IN PLACE WHEN NOT REQUIRED PROVIDED THE SIGN FACE IS FULLY COVERED.
6. TRAFFIC CONTROL DEVICES SHALL NOT BE DISPLAYED OR ERECTED UNLESS RELATED CONDITIONS ARE PRESENT NECESSITATING WARNING.
7. USE OF BARRICADES, PORTABLE BARRIER RAILS, VERTICAL PANELS, AND DRUMS SHALL BE LIMITED TO THE IMMEDIATE AREAS OF CONSTRUCTION WHERE A HAZARD IS PRESENT. THESE DEVICES SHALL NOT BE STORED ALONG THE ROADWAY WITHIN FOUR (30) FEET OF THE EDGE OF THE TRAVELED WAY BEFORE OR AFTER USE UNLESS PROTECTED BY GUARDRAIL, BRIDGE RAIL, AND/OR BARRIERS INSTALLED FOR OTHER PURPOSES FOR ROADWAYS WITH CURRENT ADTS LESS THAN 1500 AND DESIGN SPEED OF LESS THAN 60 MPH. THIS DISTANCE SHALL INCREASE TO FORTY-FIVE (45) FEET FOR ROADWAYS WITH CURRENT ADTS OF 1500 OR GREATER AND DESIGN SPEED OF 60 MPH OR GREATER OR ON THE OUTSIDE OF A HORIZONTAL CURVE. THESE DEVICES SHALL BE REMOVED FROM THE CONSTRUCTION WORK ZONE WHEN THE ENGINEER DETERMINES THEY ARE NO LONGER NEEDED. WHERE THERE IS INSUFFICIENT RIGHT-OF-WAY TO PROVIDE FOR THIS REQUIRED SETBACK, THE CONTRACTOR SHALL DETERMINE THE ALTERNATE LOCATIONS AND REQUEST THE ENGINEERS APPROVAL TO USE THEM.
8. THE CONTRACTOR SHALL NOT BE PERMITTED TO PARK ANY VEHICLES OR CONSTRUCTION EQUIPMENT DURING PERIODS OF INACTIVITY, WITHIN FOUR (4) FEET OF THE EDGE OF PAVEMENT WHEN THE LANE IS OPEN TO TRAFFIC. UNLESS PROTECTED BY GUARDRAIL, BRIDGE RAIL, AND/OR BARRIERS INSTALLED FOR OTHER PURPOSES FOR ROADWAYS WITH CURRENT ADTS LESS THAN 1500 AND DESIGN SPEED LESS THAN 60 MPH. THIS DISTANCE SHALL BE INCREASED TO FORTY-FIVE (45) FEET FOR ROADWAYS WITH CURRENT ADTS OF 1500 OR GREATER AND DESIGN SPEED OF 60 MPH OR GREATER OR ON THE OUTSIDE OF A HORIZONTAL CURVE. PRIVATELY OWNED VEHICLES SHALL NOT BE ALLOWED TO PARK WITHIN FOUR (4) FEET OF AN OPEN TRAFFIC LANE AT ANY TIME UNLESS PROTECTED AS DESCRIBED ABOVE. WHERE THERE IS INSUFFICIENT RIGHT-OF-WAY TO PROVIDE FOR THIS 4 FOOT SETBACK, THE CONTRACTOR SHALL DETERMINE THE ALTERNATE LOCATIONS AND REQUEST THE ENGINEER'S APPROVAL TO USE THEM.

9. ALL DETOUR AND CONSTRUCTION SIGNING SHALL BE IN STRICT ACCORDANCE WITH THE MANUAL ON UNIFORM TRAFFIC CONTROL DEVICES.
10. ALL DETOURS SHALL BE PAVED, STRIPED, SIGNED AND THE VERTICAL PANELS ARE TO BE IN PLACE BEFORE IT IS OPEN TO TRAFFIC.
11. ALL CONSTRUCTION ACTIVITIES SHALL BE COMPLETED IN FULL COMPLIANCE WITH THE AMERICANS WITH DISABILITIES ACT (ADA) AND ARCHITECTURAL AND TRANSPORTATION BARRIERS COMPLIANCE BOARD, FEDERAL REGISTER 36 CFR PARTS 1190 AND 1191, ACCESSIBILITY GUIDELINES FOR BUILDINGS AND FACILITIES, ARCHITECTURAL BARRIERS ACT (ABA) ACCESSIBILITY GUIDELINES, PROPOSED RULE. PUBLISHED IN THE FEDERAL REGISTER ON JULY 1, 2010, AS HAS BEEN ADOPTED BY METRO.

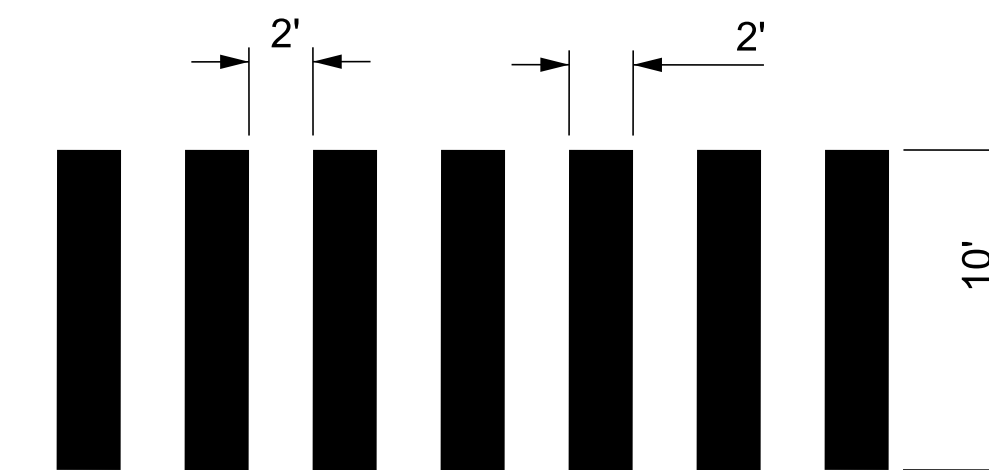

**CROSSWALK  
DETAIL**

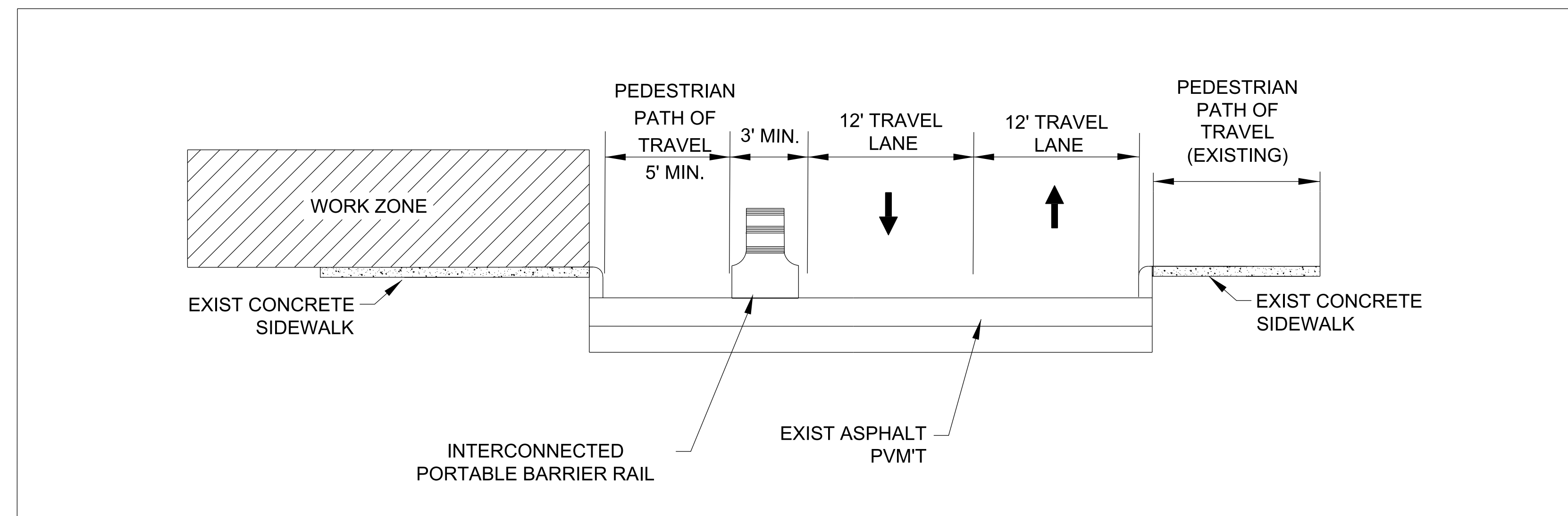

**TYPICAL SECTION  
EWING AVENUE**

FILE NO.	00041533_001
DATE:	09/17/2024
DESIGNED BY:	TJB
DRAWN BY:	JMG
CHECKED BY:	JAM

REVISION BLOCK		
DATE:		

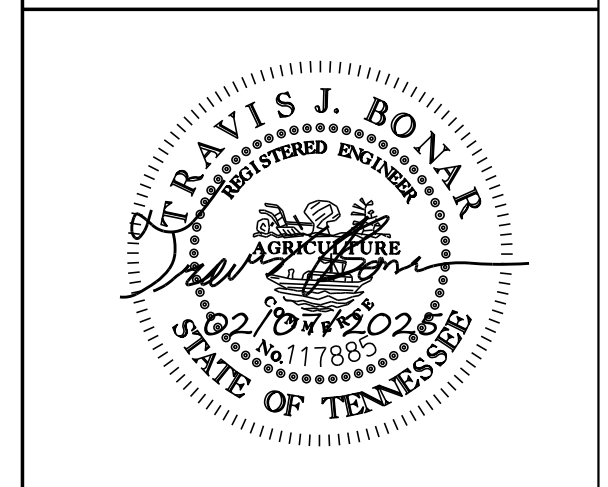
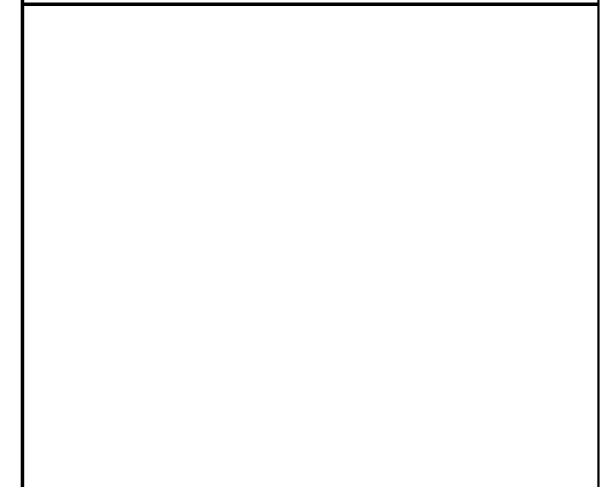
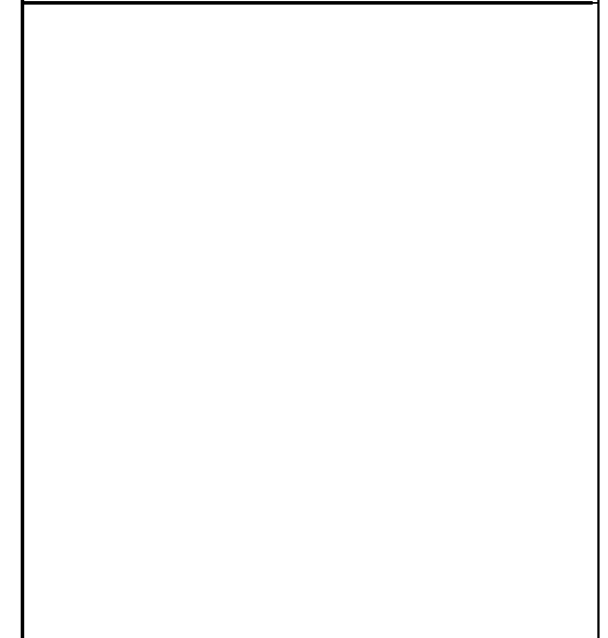
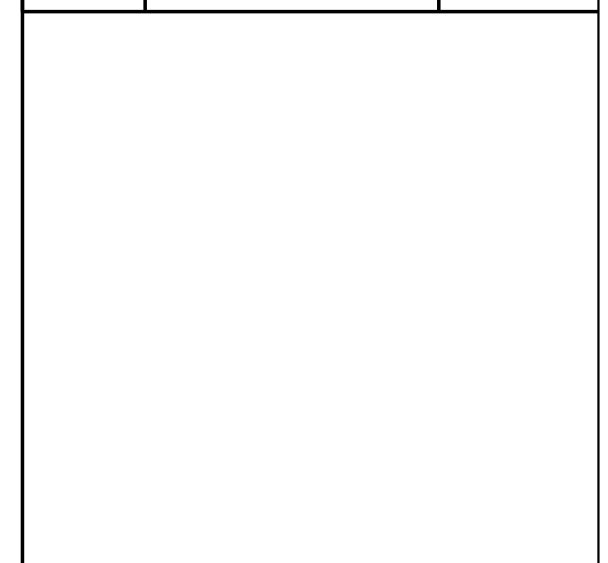

**GENERAL NOTES  
AND TYPICAL  
SECTIONS**

**WALT  
GRACE  
TTC**

TCP LAYOUT

SCALE: N.T.S.

SHEET 3